

Instruction for Solvent-based White

【Handling Instruction】

1. Store the cartridge with its nozzles up as shown in Photo 1.
2. Before installing the cartridge in a printer, shake the cartridge up and down for **30 seconds** with the nozzles down as shown in Photo 2 to maintain optimal printing conditions.
 - **Do not shake the cartridge strongly. It may cause damage to the ink cartridge.**
3. After shaking the cartridge, remove its cover and wipe extra ink with a lint-free dry cloth as shown in Photo 3.
 - **Do not wipe the nozzles with water.**
 - **When the nozzles are dirty with ink, clean the print head with a lint-free cloth.**

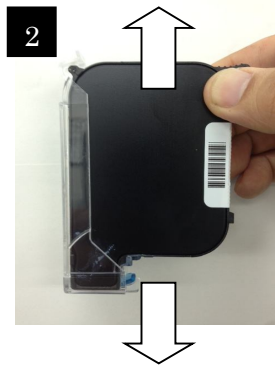
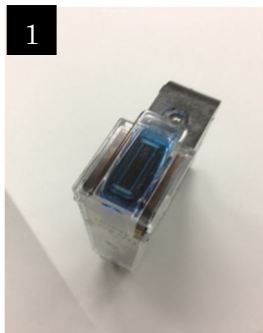

4. Conduct a printing performance test before running it.
If the performance is not satisfactory, follow instruction 2, 3, and 4 again.



5. After every use, to prevent nozzles drying out, wipe excess ink again with a lint-free dry cloth and cover the cartridge with its original clip. Make sure the cartridge is stored "Nozzle Up".



6. Please use both nozzle rows for printing operation.
7. When the cartridge is not used for more than one hour, please store the cartridge with its cover and store "Nozzle Up".

Caution

1. The whiteness may vary during printing due to the nature of the ink.
2. The white ink cartridge may show nozzle missing on daily use. Please shake and wipe the cartridge by following this instruction when it happens.